

LEGAL DECK SECTION

1. BUILDING FOOTING SHALL BE 2\"/>

- GENERAL NOTES**
1. BUILDING FOOTING SHALL BE 2" WIDE AND 12" DEEP AT ALL CORNERS AND UNDER ALL WALLS.
 2. THE BUILDING SHALL BE SET ON A CONCRETE FOUNDATION.
 3. NO DEMOLITION WORK SHALL BE PERMITTED UNTIL ALL NECESSARY PERMITS ARE OBTAINED.
 4. THE CONTRACTOR SHALL BE RESPONSIBLE FOR OBTAINING ALL NECESSARY PERMITS.
 5. ALL NEW CONCRETE SHALL BE PLACED AND FINISHED IN ACCORDANCE WITH THE SPECIFICATIONS.
 6. ALL NEW CONCRETE SHALL BE CURED FOR A MINIMUM OF 7 DAYS.
 7. PROTECT EXISTING UTILITIES.
 8. THE CONTRACTOR SHALL BE RESPONSIBLE FOR OBTAINING ALL NECESSARY PERMITS.
 9. ALL ROOFING SURFACES SHALL BE PROTECTED WITH A PROTECTIVE COAT.
 10. PROTECT EXISTING UTILITIES.
 11. PROTECT EXISTING UTILITIES.
 12. PROTECT EXISTING UTILITIES.
 13. PROTECT EXISTING UTILITIES.
 14. PROTECT EXISTING UTILITIES.
 15. PROTECT EXISTING UTILITIES.

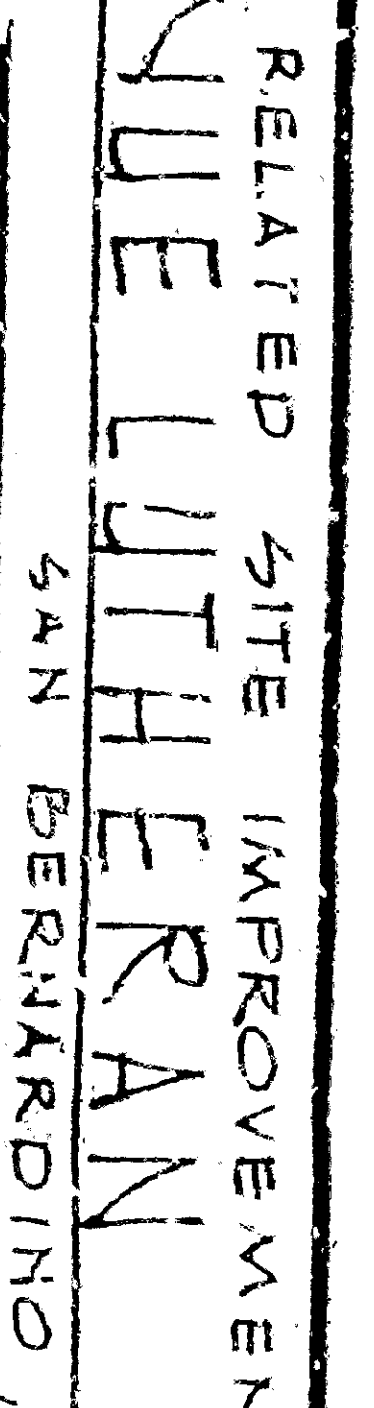
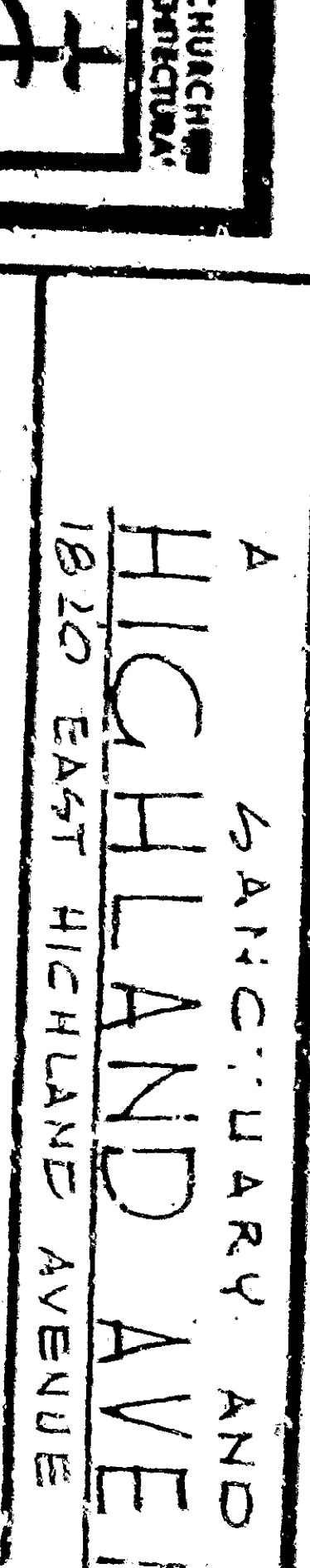
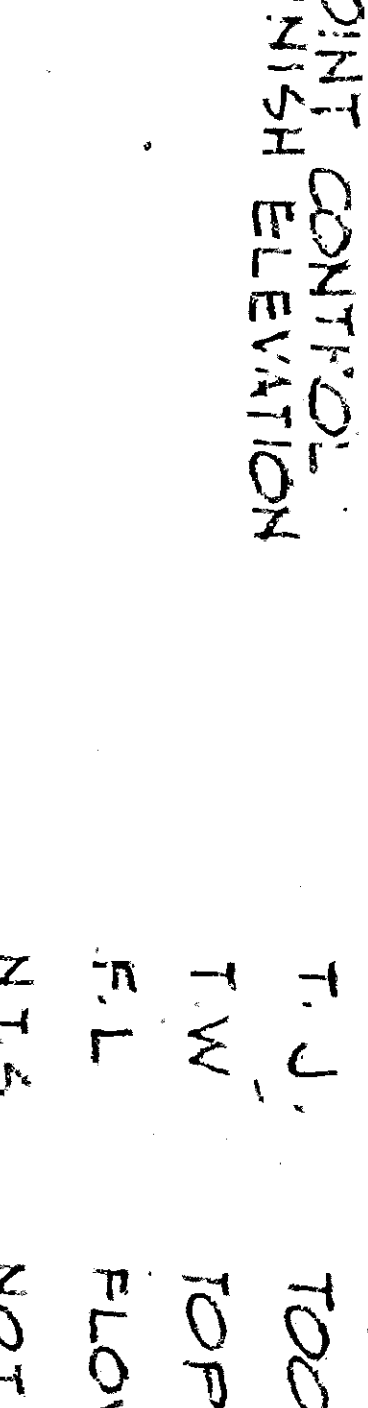
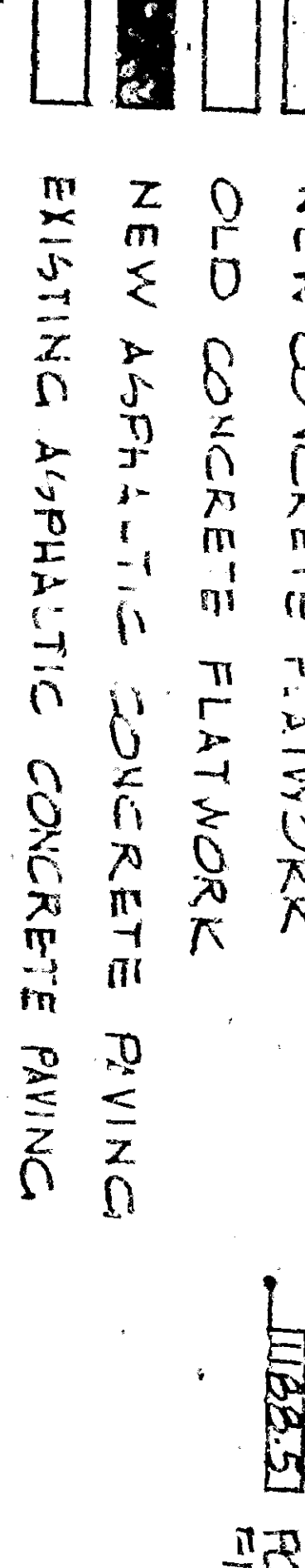
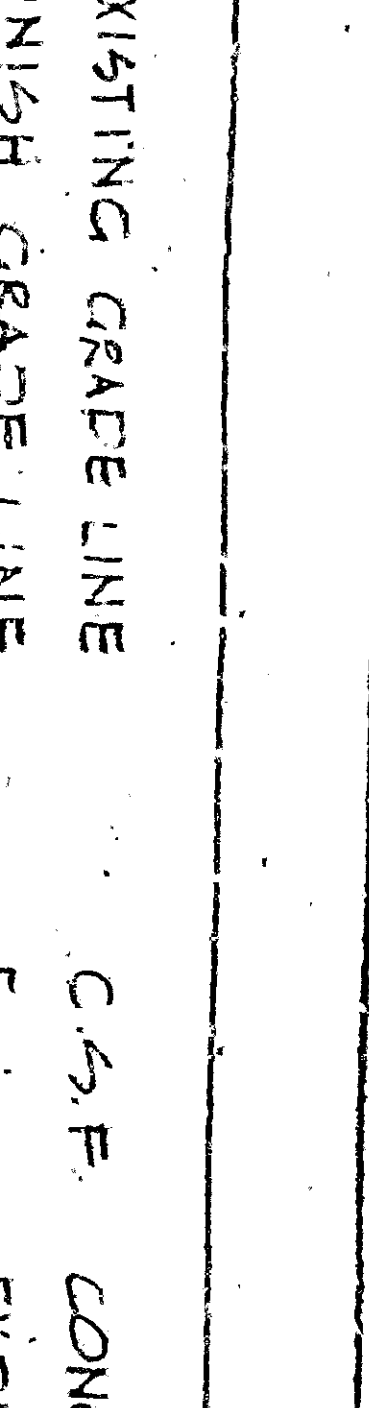
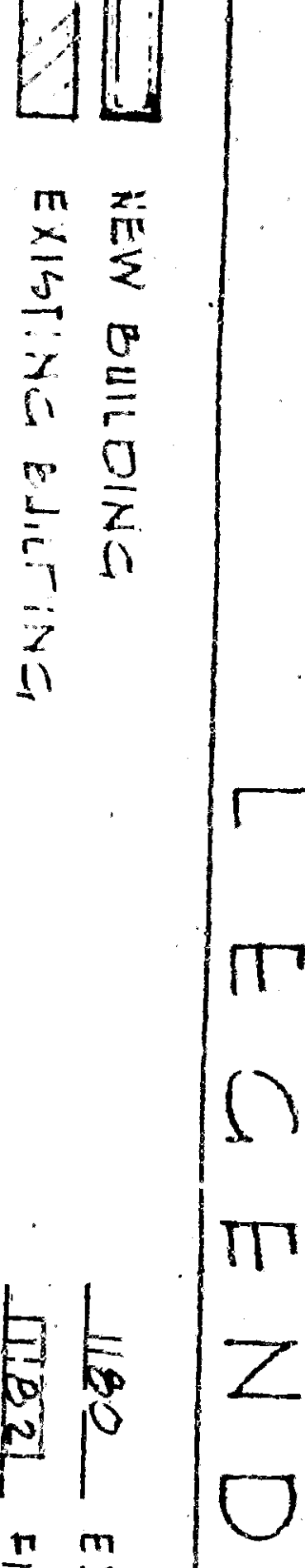
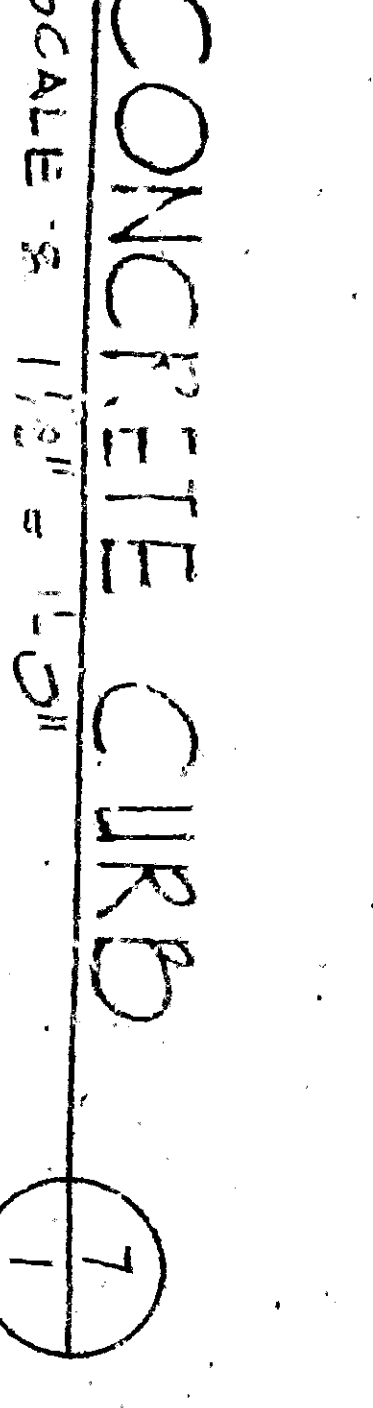
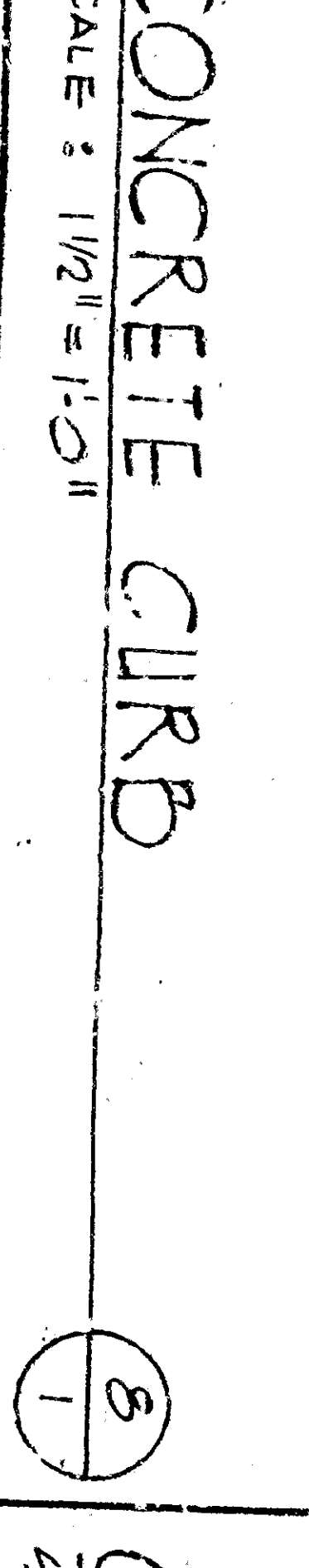
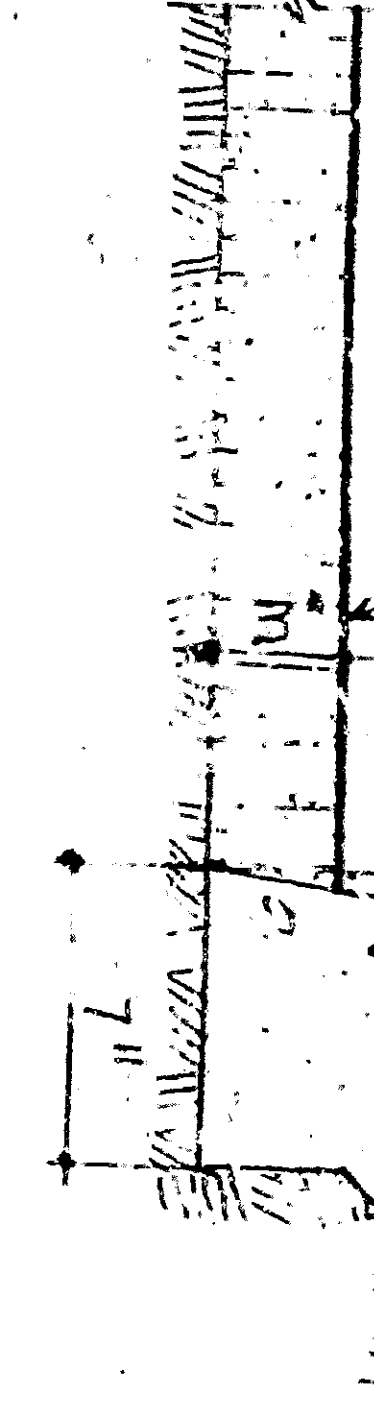
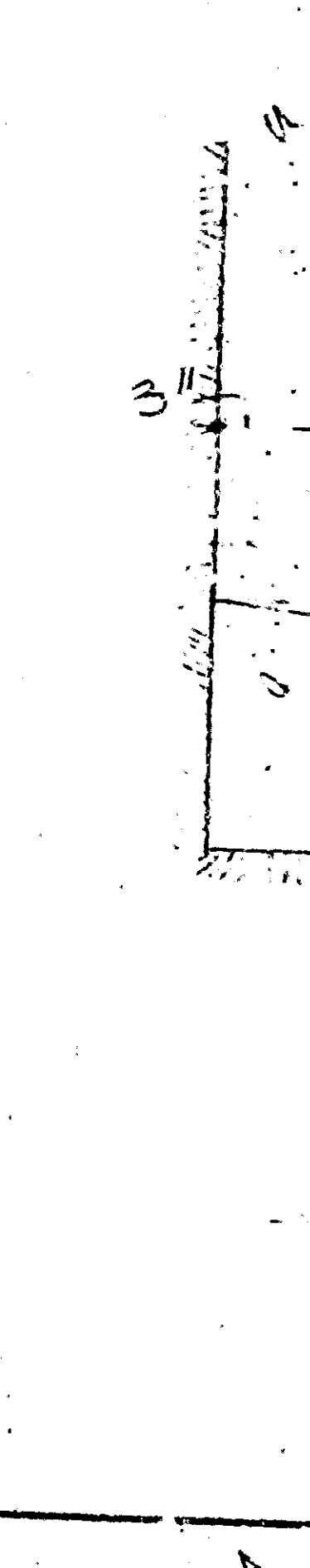
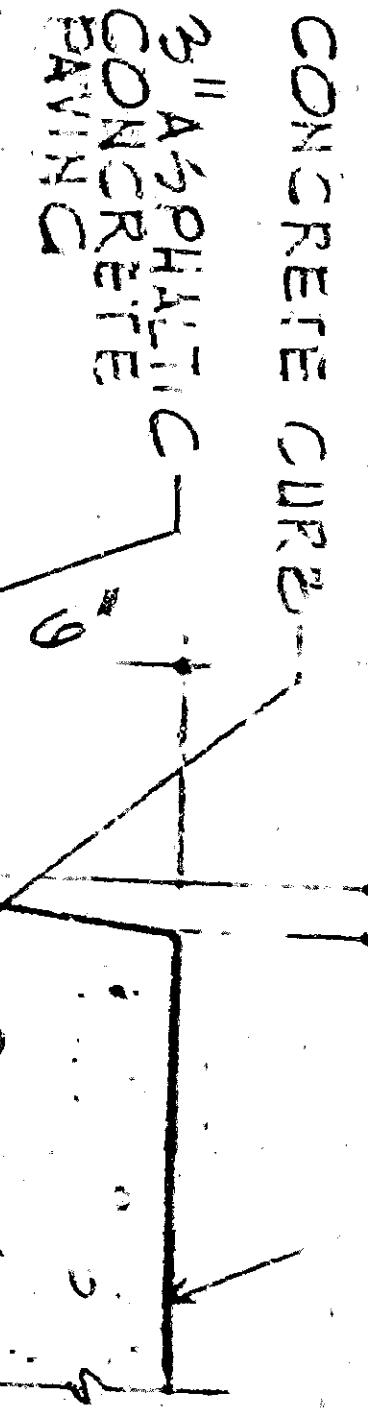
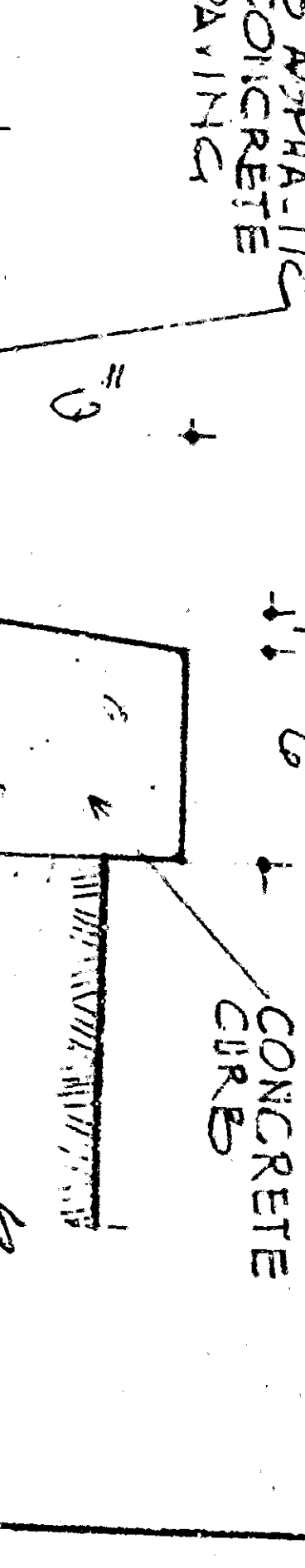
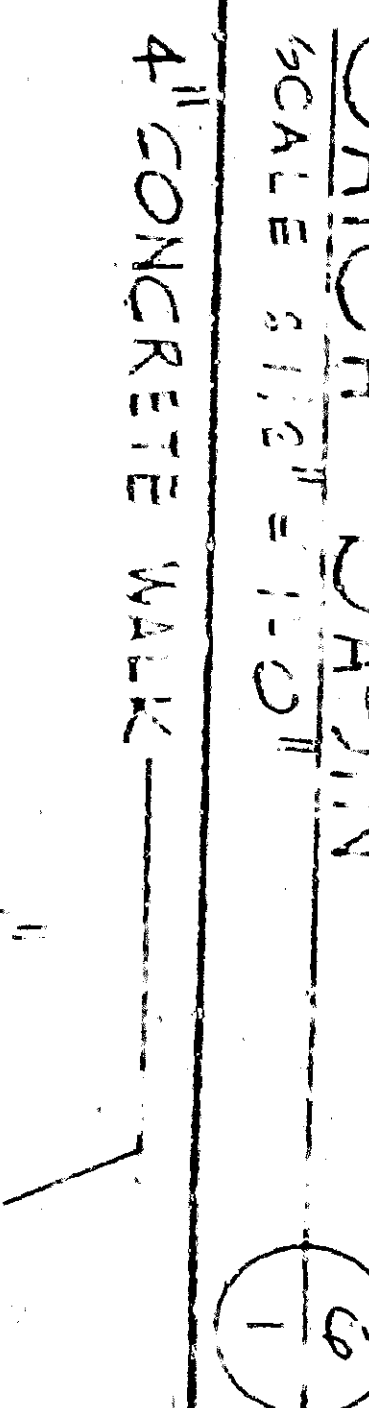
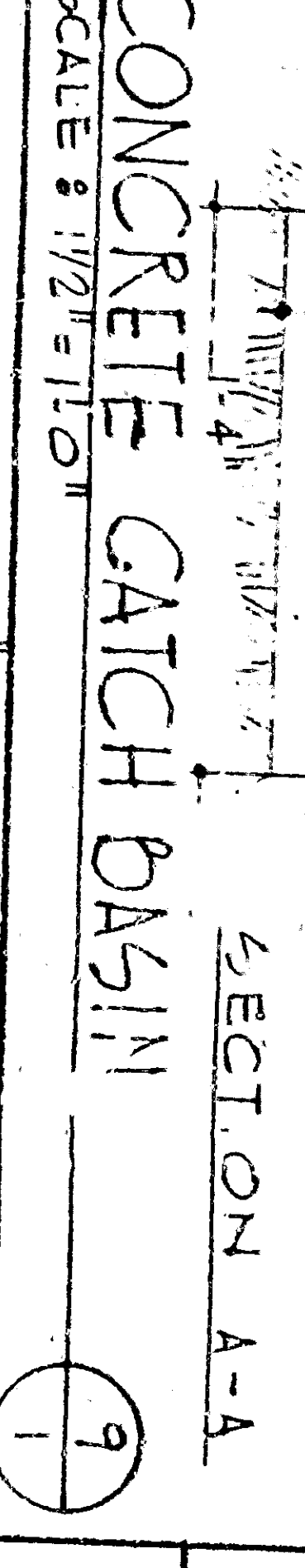
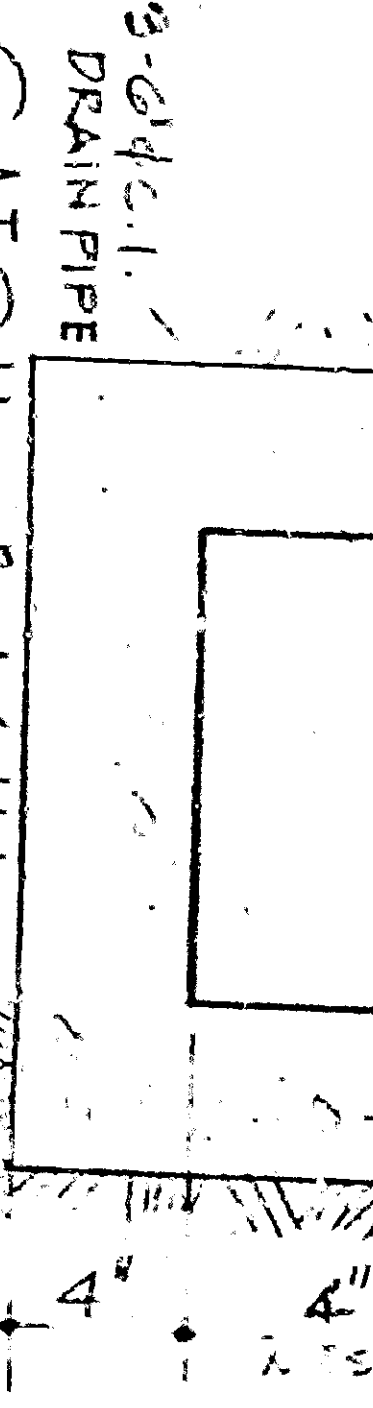
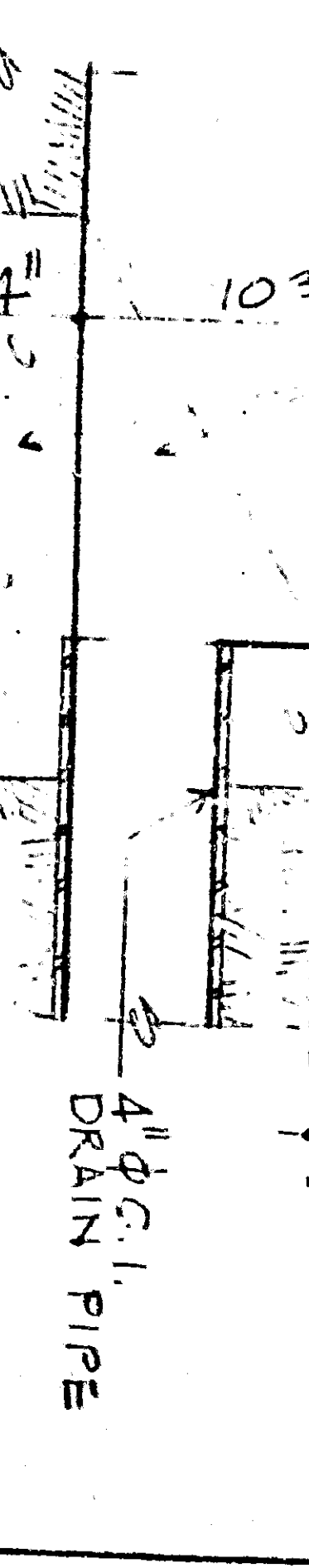
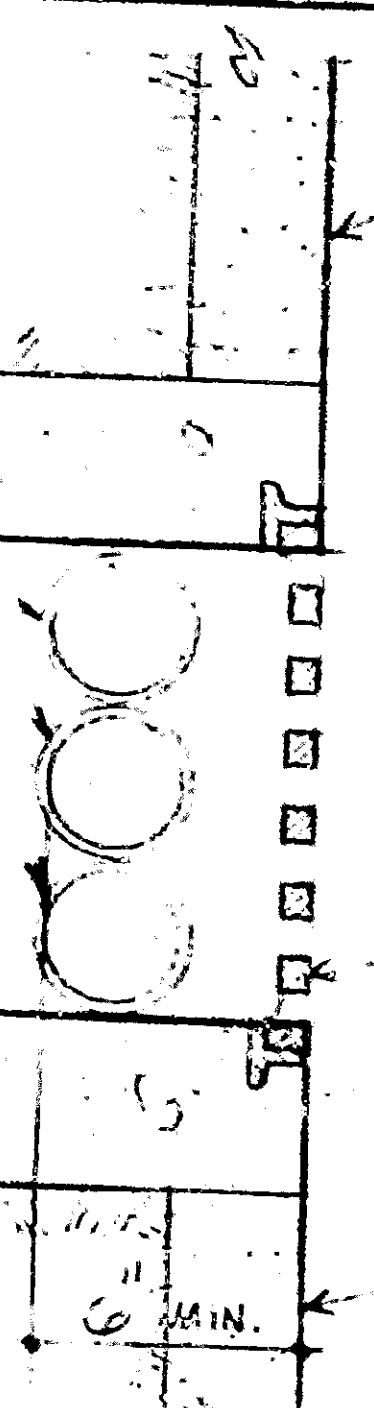
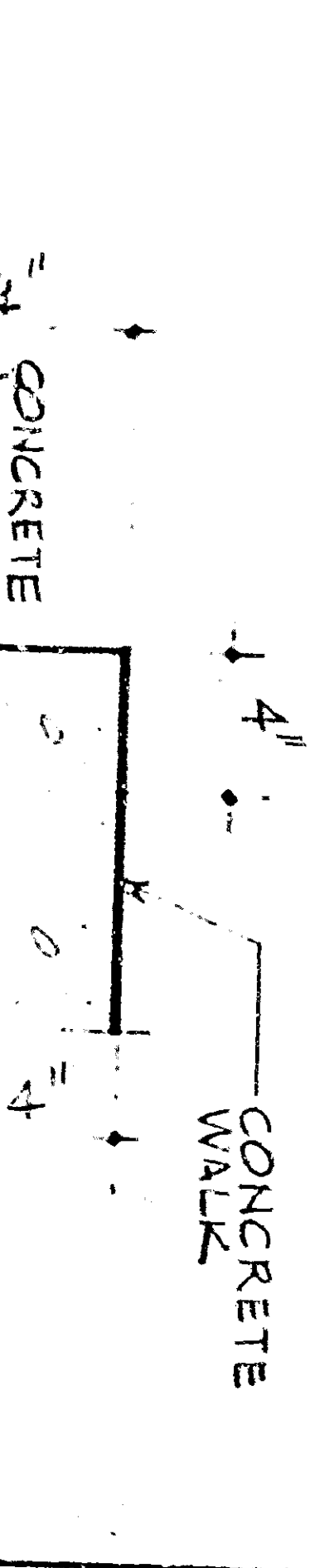
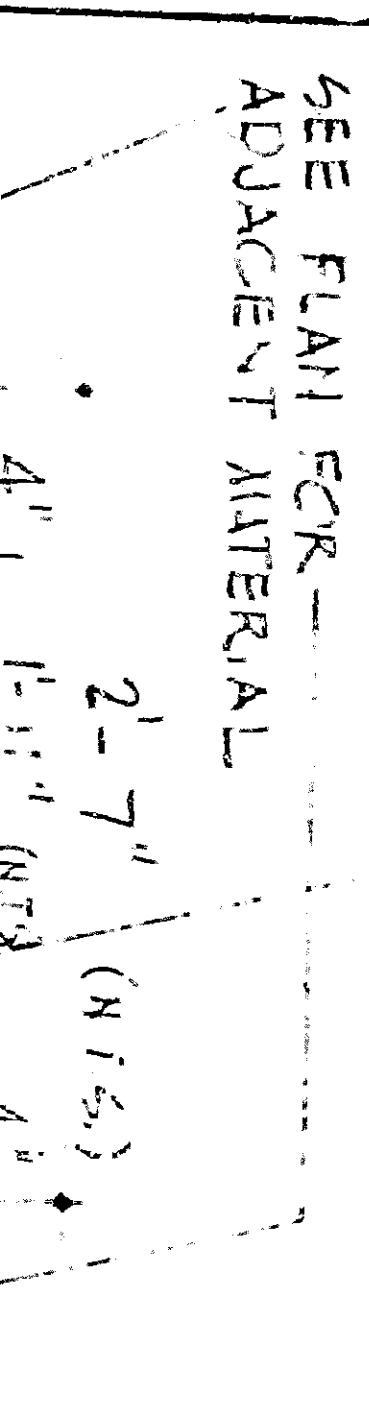
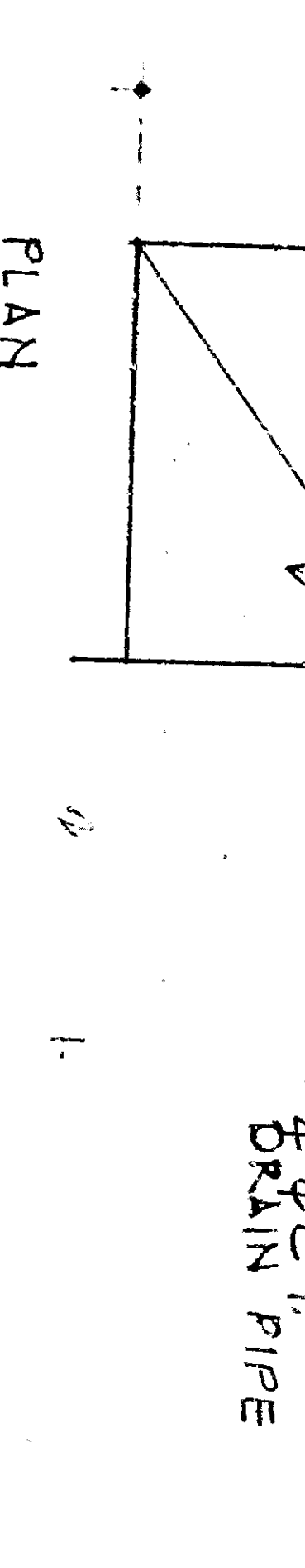
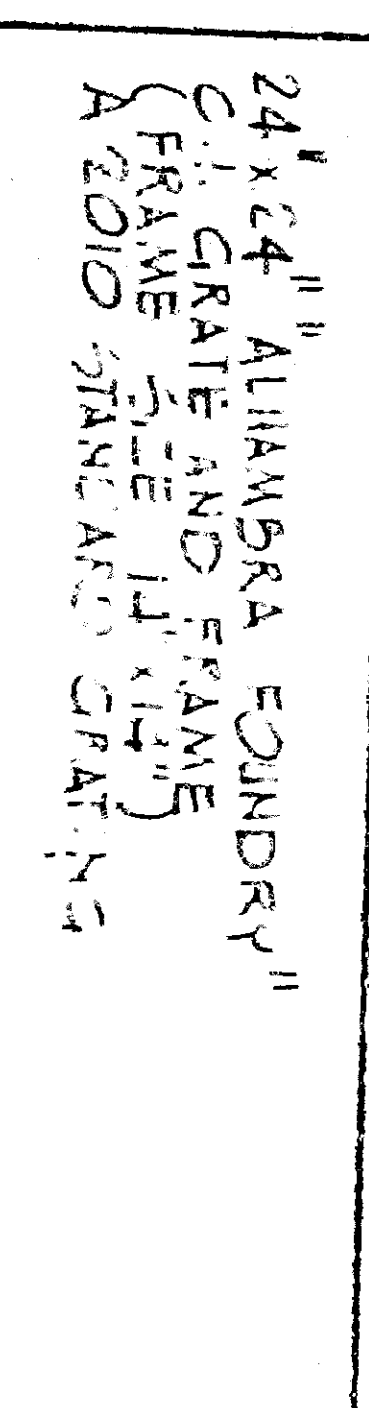
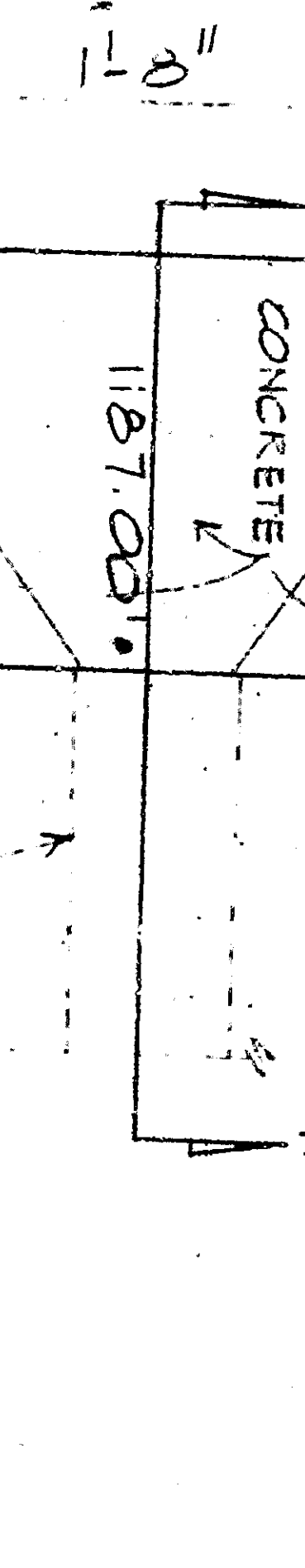
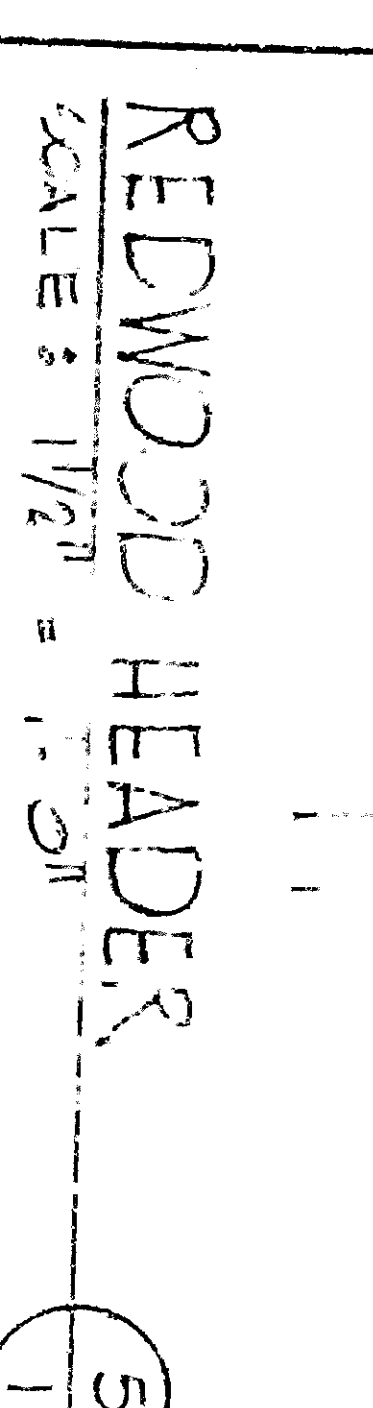
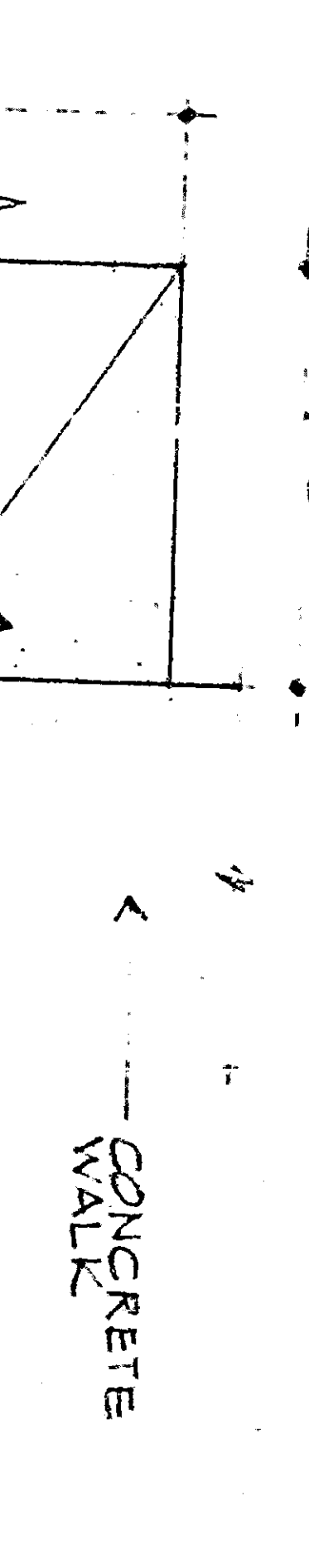
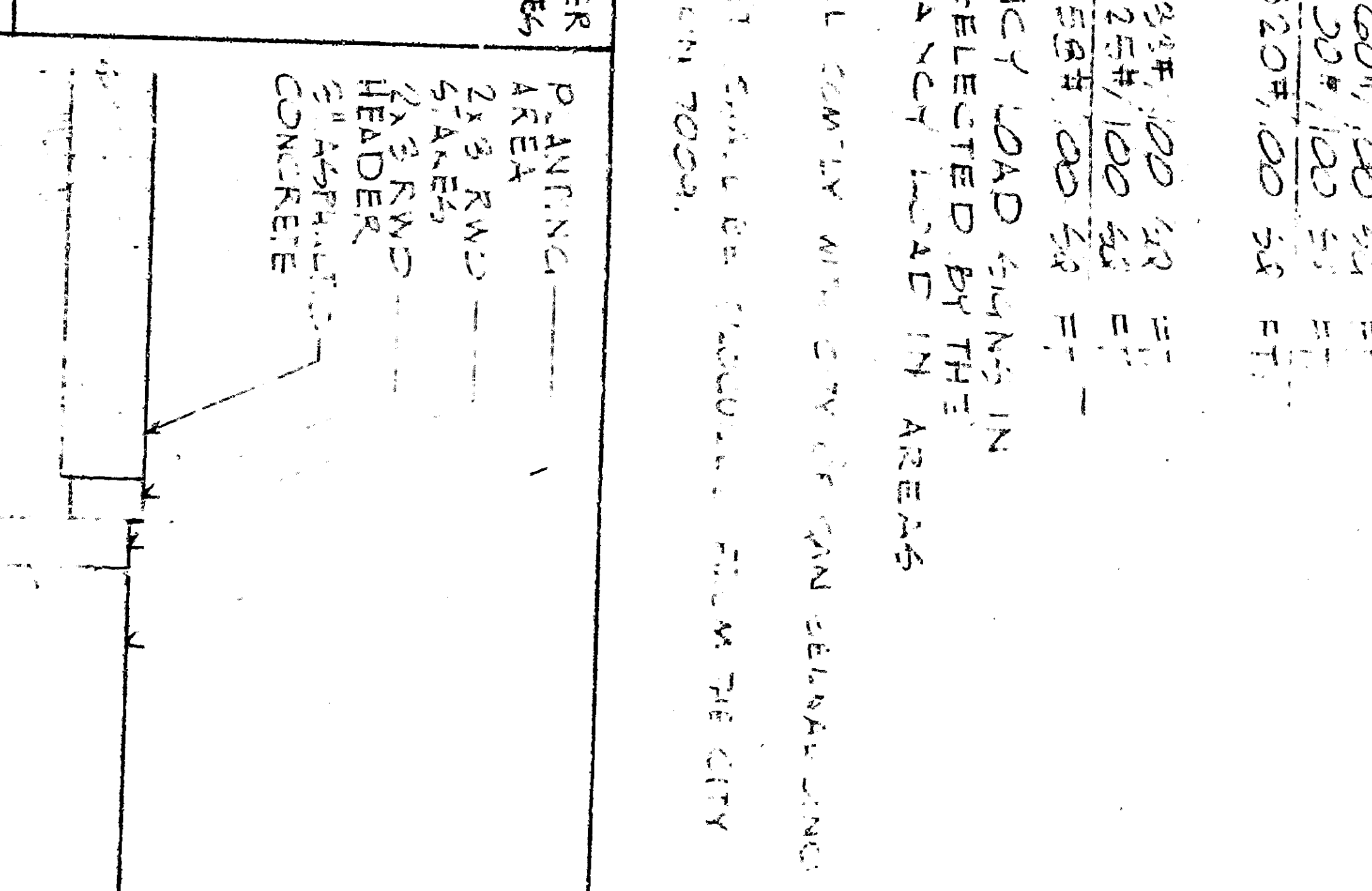
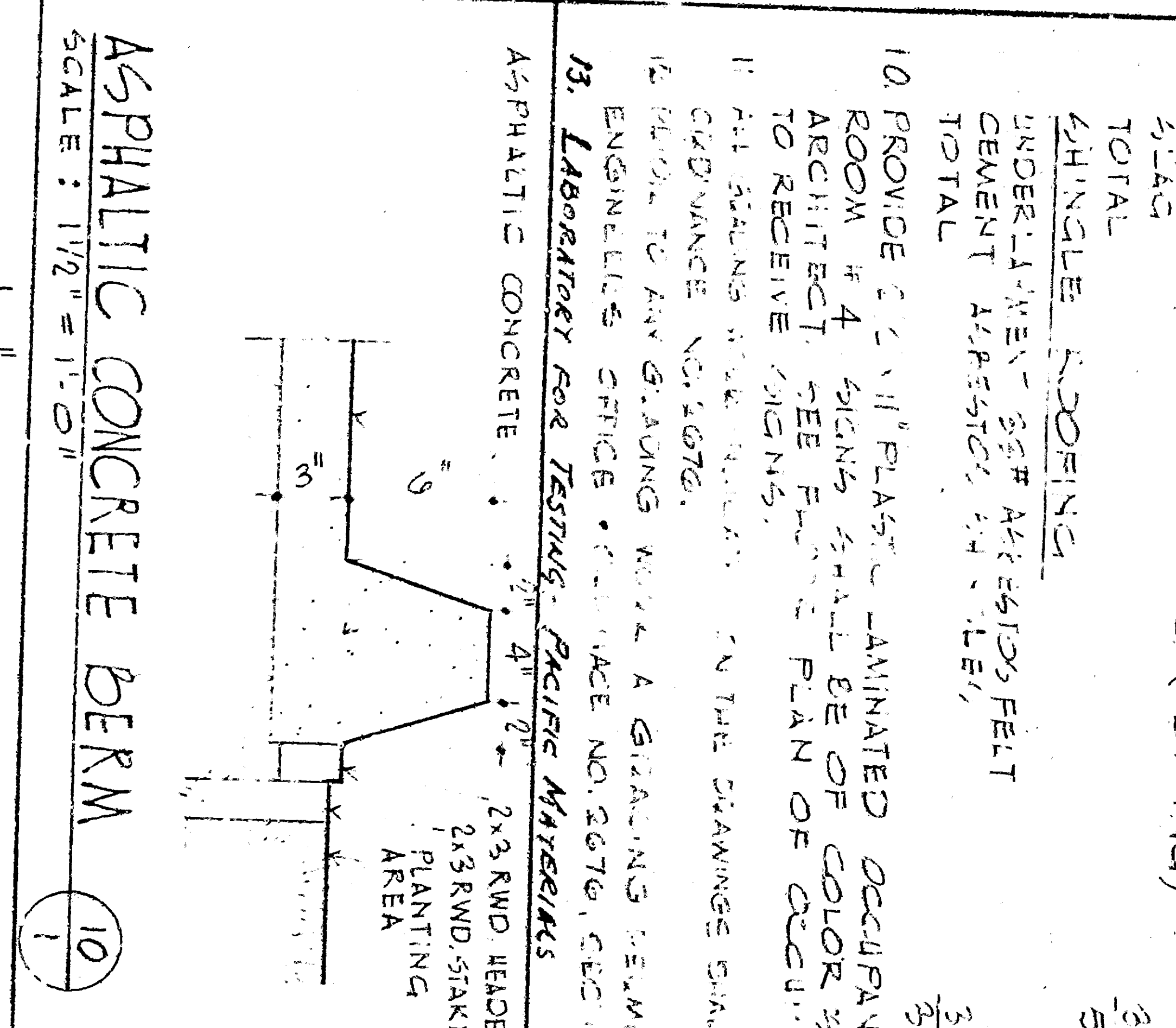

LEGEND

1. NEW BUILDING	2. EXISTING BUILDING	3. C-4-F CONCRETE SALT FINISH
4. NEW CONCRETE FINISHWORK	5. OLD CONCRETE FINISHWORK	6. E-3 EXPANSION JOINT
7. NEW ASPHALTIC CONCRETE PAVING	8. EXISTING ASPHALTIC CONCRETE PAVING	9. T-1 TOUGH JOINT
		10. TOP OF WALL
		11. F.L. FLOW LINE
		12. NOT TO SCALE